

Reel Winder

Quick Start Guide

1 - Wiring

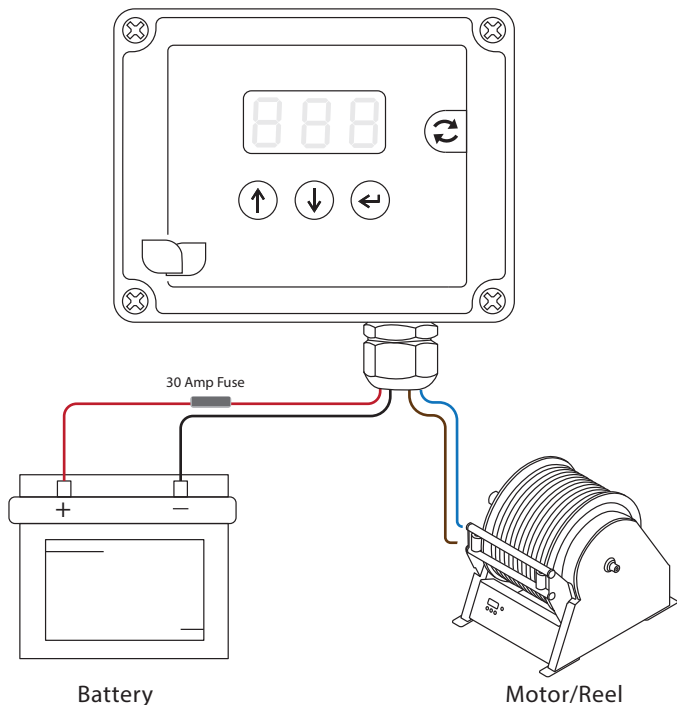

Connect the Reel Winder in accordance with this diagram.

NOTE: only fit the fuse once all connections are made. Motor/Reel



Make sure correct fuses are fitted inline. Failure to do so will result in damage to the unit. Observe correct battery polarity. Failure to do so may result in damage to the unit.

WE ADVISE THAT THESE SAFETY INSTRUCTIONS ARE AFFIXED TO THE REEL SO THAT THEY ARE CLEARLY VISIBLE TO THE REEL OPERATOR.

! SAFETY INSTRUCTIONS !

Follow these instructions carefully to ensure safe operation of this unit.

1. Appropriate Personal Protection Equipment must be worn when operating this unit, eg: goggles and gloves.
2. Warning cones or signs must be used to alert the public to potential danger.
3. If the push button operator cannot see the far end of the hose, then another operator must be present to keep an eye on the hose as it rewinds.
4. Release the push button control immediately if the hose snags or reel stops.
5. Release the push button control immediately if the hose presents a danger to any person or animal.
6. Do not exceed the maximum safe speed of operation.
7. Do not override or change the factory settings.
8. This unit must be serviced every 12 months.

2 - Operation

Turn on the controller by pressing the up button.



The controller will flash between the current speed setting and StP.



2 - Operation

Use the up or down button to change between the speed setting. This can be set from 1 to 4, 4 being the fastest.



To wind the reel, press and hold the wind button. Release the button when winding is complete. Whilst winding the controller will stop displaying StP.



Press and hold the up and enter buttons to enter CAL (calibration). This can be set between 1 and 99, and adjusts how sensitive the SNg (snag) is. Use the up or down button to adjust this setting accordingly. Press enter to set.



Press and hold the down and enter buttons to enter the brake settings. brA will be displayed. The brake can be switched On or Off by using the up and down buttons.



To turn the controller off, press and hold the enter button.



3 - Troubleshooting



The motor wires have been disconnected. Check wiring, if message continues contact distributor.



The hose has snagged because of an obstruction.



An over current has been detected, the controller has shut down the motor to protect itself. Contact distributor.

4 - Controller Options

WFP Link - Radio Remote Control

The reel winder can be fitted with a WFP Link. Each button on the fob corresponds to a speed on the controller.

Press and hold the desired speed button on the fob to wind the reel in. The LEDs on the fob will light up according to which button has been pressed.

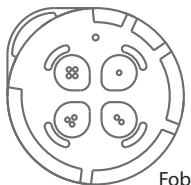

Hard Wired Pendant Control

The reel winder can be fitted with an external push button switch* (pendant) to start/stop winding further away from the controller.

To connect the external push button switch disconnect the controller from power and open the enclosure. Wire the external switch button through the empty gland on the enclosure and to the terminal block (shown below). It does not matter which way round the wires are fitted.

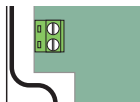

*Not supplied



RELEASE THE PUSH BUTTON CONTROL IMMEDIATELY IF THE HOSE SNAGS OR THE REEL STOPS.

RELEASE THE PUSH BUTTON CONTROL IMMEDIATELY IF THE HOSE PRESENTS A DANGER TO ANY PERSON OR ANIMAL.

- Appropriate Personal Protection Equipment must be worn when operating this unit, eg goggles and gloves.
- Warning cones or signs must be used to alert the public to potential danger.
- If the push button operator cannot see the far end of the hose, then another operator must be present to keep an eye on the hose as it rewinds.

| Specification | Value |
|---------------------|--------------------|
| Supply Voltage | 11 - 15 VDC |
| Maximum Current | 35A (Peak) |
| Fuse | 30A |
| Enclosure Material | Polycarbonate |
| Water Resistance | IP65 |
| Dimensions | 115 x 90 x 55 (mm) |
| Working Temperature | 0 to 40 Deg C |

Unit must be installed by a competent electrician or electrical engineer. Failure to comply with these instructions could invalidate your warranty.

DISCLAIMER

THE MANUFACTURER RESERVES THE RIGHT TO MAKE CHANGES TO ANY PRODUCT HEREIN TO IMPROVE RELIABILITY, FUNCTION OR DESIGN. THE MANUFACTURER DOES NOT ASSUME ANY LIABILITY ARISING OUT OF THE APPLICATION OR USE OF ANY PRODUCT OR CIRCUIT DESCRIBED HEREIN.

For more information and videos on how to use Spring controllers please visit: www.springltd.co/videos

Copyright © 2021 Spring (Europe) Ltd. All rights reserved.

European Patent: 3835575

VERSION 1

RELEASE 14.06.24

ECO Reference

ECO0226